

**EVEREST COLLEGE – SAN FRANCISCO
ABBREVIATED INSTITUTIONAL MASTER PLAN
PLANNING CODE SECTION 304.5
AUGUST 1, 2010**

PURPOSE OF THE ABBREVIATED INSTITUTIONAL MASTER PLAN

This Abbreviated Institutional Master Plan (AIMP) is submitted pursuant to Planning Code section 304.5 for Everest College - San Francisco (Everest) located at 814 Mission Street. Because Everest occupies less than 50,000 square feet and does not anticipate expanding beyond that capacity, a full institutional master plan is not required.

ABOUT EVEREST COLLEGE

Purpose: Everest provides post-secondary education programs that prepare students for careers in healthcare.

History: The San Francisco campus was among the original Bryman Schools founded in 1960 by Mrs. Esther Bryman the Los Angeles Colleges of Medical and Dental assistants. The San Francisco campus opened in 1970. The school was acquired by National Education Corporation in 1975. In 1983 the school name was changed to National Education Center. Corinthian Schools, Inc. acquired the school in July 1995. The school name was changed to Bryman College in June 1996 and subsequently changed to Everest College in October 2006.

Curriculum: Everest provides diploma programs that prepare students for occupations in healthcare. The school's programs are as follows:

- Dental Assisting
- Massage Therapy
- Medical Assisting
- Pharmacy Technician

Accreditation: Everest is accredited by the Accrediting Commission of Career Schools and Colleges (ACCSC), an institutional accrediting body recognized by the U.S. Department of Education. Additionally, the Medical Assisting program is accredited by the Commission on Accreditation of Allied Health Education Programs (CAAHEP) upon the recommendation of the Medical Assisting Education Review Board (MAERB) and the Dental Assisting program has been approved by the Dental Board of California which allows graduates to apply for the Registered Dental Assistant Examination (RDA).

Student Population and Characteristics: The San Francisco campus of Everest College has a current fulltime student population of approximately 400 students (August 2010). All of the students are residents of the greater Bay Area. The demographics of the student population are as follows:

<u>Gender</u>	
Male	11%
Female	89%

<u>Age</u>	
Under 25	21%
25 – 34	51%
35 – 44	22%
45 – over	6%

<u>Ethnicity</u>	
White/Non-Hispanic	34%
Black/Non-Hispanic	28%
Hispanic	13%
Asian/Pacific Islander	25%

Staff and Faculty: Everest College has a staff of 60 of whom 25 are instructors. All staff live within the greater Bay Area.

Affirmative Action: Everest College is an equal opportunity employer and makes employment decisions on the basis of merit only. Everest policy prohibits unlawful discrimination based on race, gender, gender identity, religion, marital status, age, national origin, ancestry, physical or mental disability, legally protected medical conditions, sexual orientation, family care or medical leave status, veteran status, or any other consideration made unlawful by federal, state or local laws. Discrimination based on the perception that someone has any of those characteristics or because someone is associated with a person who has or is perceived to have any of those characteristics is also prohibited. This same policy also applies to students enrolling in our school.

CURRENT FACILITIES

Location: Since 1998, the school has been located at 814 Mission Street, Suite 500, in downtown San Francisco.

Size: The school occupies 31,000 square feet on three floors of the office building in which it is located. The school is currently planning a 5,500 square foot expansion.

Ownership: Neither Everest College nor its parent corporation, Corinthian Colleges, Inc., owns any real property in the city or county of San Francisco and has no current plans to acquire any real property in San Francisco.

Parking: There is no off-street parking provided at 814 Mission Street, which is centrally located in the main downtown area. There are several commercial parking lots near the school facility. Most students and staff commute to school using public transportation. The school is conveniently located near multiple bus routes and is a block away from a BART station.

Student Housing: Everest College does not own or operate student housing, nor does it provide direct assistance to students to obtain housing.

Proposed Changes: Everest College is currently planning to expand the school facility by 5,500 square feet.

FOR EVEREST COLLEGE – SAN FRANCISCO

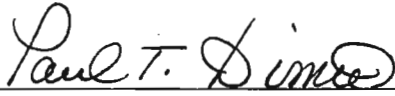

Paul Dimeo
Vice President, Facilities & Operations
Corinthian Colleges, Inc.

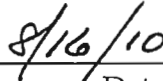

Date



FOURTH FLOOR



SECOND FLOOR

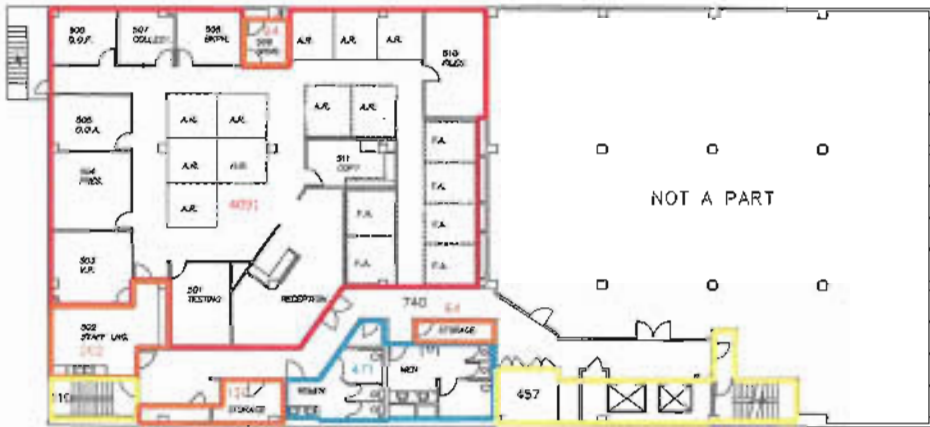

FIFTH FLOOR

	2ND FLOOR	4TH FLOOR	5TH FLOOR	COMBINED	
— ADMINISTRATION	726 SF	1,247 SF	4,091 SF	6,064 SF	22% OF TOTAL
— LECTURE	4,005 SF	1,189 SF	— SF	5,195 SF	19% OF TOTAL
— LAB	2,544 SF	3,314 SF	— SF	5,858 SF	21% OF TOTAL
— PC	826 SF	1,830 SF	— SF	2,456 SF	9% OF TOTAL
— SUPPORT	918 SF	1,463 SF	510 SF	2,891 SF	11% OF TOTAL
— RESTROOMS/JAN.	261 SF	316 SF	471 SF	1,048 SF	4% OF TOTAL
— CORRIDOR/ENTRY	1,473 SF	1,739 SF	740 SF	3,952 SF	14% OF TOTAL
TOTAL	10,754 SF	10,898 SF	5,812 SF	27,464 SF	
— ELEVATOR/STAIRS - NOT INCLUDED IN TOTALS			1,462 SF		



183 SAN FRANCISCO